



Daikin Air Conditioning

Home heating and cooling solution.

Slim Concealed Ceiling Unit FDKS/FDXS

Please check
<http://global-cooling.co.uk>
for the latest information.

UK PRICE LIST ATTACHED



For more information

<http://global-cooling.co.uk/airconditioning/air-conditioning-brands/daikin-air-conditioning/concealed-air-conditioning/>

If you need any help please **call us on 01200 428888**

Global Cooling Air Conditioning UK

www.global-cooling.co.uk
Upbrooks Industrial Estate
Clitheroe, Lancashire
BB7 1PL, UK

UK Air Conditioning Online Shop - <http://global-cooling.com/>

Air Conditioning Forum - <http://air-conditioning-forum.global-cooling.co.uk/>

Daikin air conditioners
for your home

SLIM CONCEALED CEILING UNIT

R-410A



www.daikineurope.com

FDKS/FDXS-E/C





This slim unit is installed within the ceiling. It's barely noticeable, only the suction and discharge grilles are visible. Therefore this system blends unobtrusively within any interior décor, leaving maximum floor and wall space for furniture, decoration and fittings.

COMFORT

- Top-class **quiet operation sound level** of only 29 dB(A) is achieved. This is 5 dB(A) quieter than that of conventional models and can be compared with rustling leaves.
- You have the choice of **5 fan speeds** to select: from high to super low.
- Daikin's special **dry programme** reduces humidity in the room without variations in room temperature.
- The **powerful operation** function boosts the air flow to a maximum volume for a 20-minute period, (e.g. when you come home on a hot day, rapid cooling is required). After this, the unit returns automatically to its previous settings.
- The **night set mode** is automatically selected by pushing the 'off' timer button. This function prevents any sudden change in room temperature by gently raising/lowering the temperature before the air conditioner stops, so you can sleep more comfortably.
- The **outdoor unit silent operation** function increases comfort by automatically lowering the operating sound of the outdoor unit by 3dB(A).



- The **night quiet mode** reduces the operating sound of the outdoor unit by another 3 dB(A) at night (only in combination with Multi models).

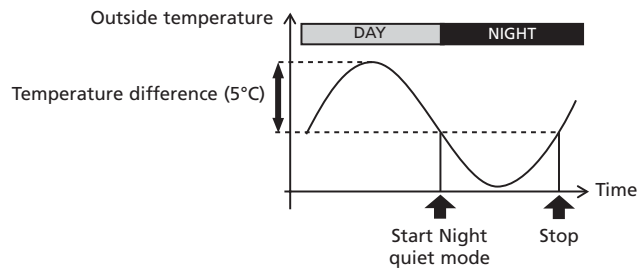

FILTER

- This slim concealed ceiling unit is equipped as standard with a suction filter, which removes airborne dust particles to ensure a steady supply of clean air.

FLEXIBLE INSTALLATION AND EASY TO USE AND MAINTAIN

- The outdoor unit can be installed on a roof or terrace or placed against an outside wall.
- Daikin remote controls give you **easy control at your fingertips**.
- Malfunction codes are shown on the digital display panel of the infrared remote control for **fast and easy maintenance**.
- Special anti-corrosion treatment of the outdoor unit's heat exchanger fin, gives **great resistance against acid rain and salt corrosion**. Additional resistance is provided by a rust proof steel sheet on the underside of the unit



Infrared remote control (Standard)



ENERGY EFFICIENT

- Energy label: up to class B
- **Inverter technology:**
Improved energy efficiency:
The use of integrated inverter control ensures maximum **energy efficiency** by supplying only the required heating or cooling load where a standard non inverter unit would supply maximum load in an on/off regime.

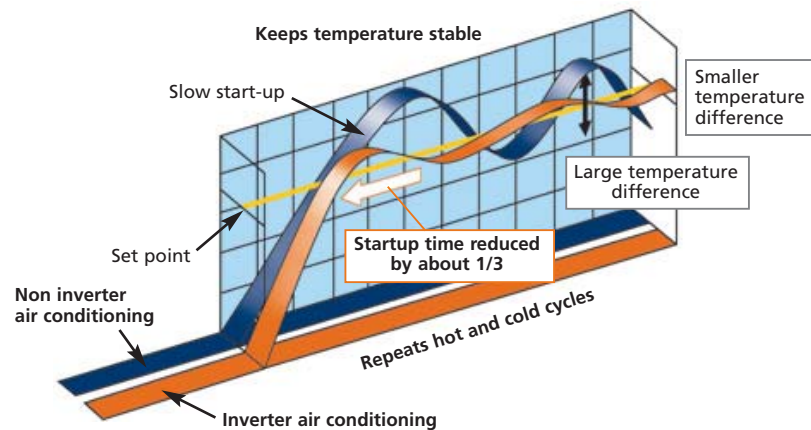

- Improved comfort:
The rapid start up time provided by the inverter increases the **comfort** by reducing the lead time in obtaining the required indoor temperature. Once the required temperature is reached, the inverter unit continuously scans the room for small changes and adjusts the room temperature in seconds thereby increasing comfort once again.
- The **home leave** button prevents large temperature differences by continuously operating at a minimum (heating mode) or maximum (cooling mode) preset level while you're out or sleeping. It also allows the indoor temperature to return quickly to your favourite comfort level.

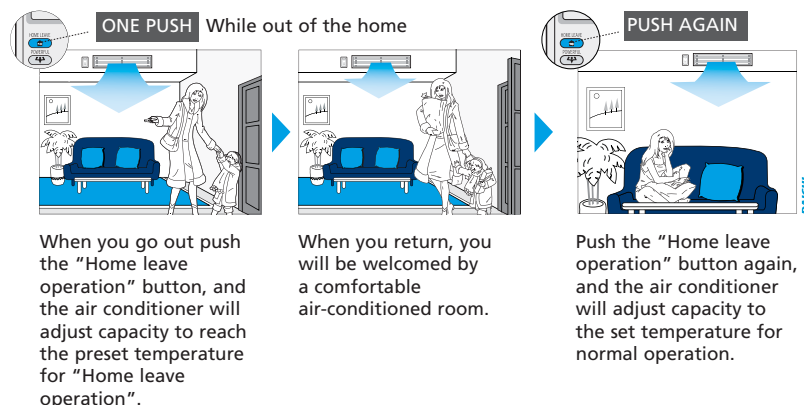

APPLICATION OPTIONS

- This model can be used for cooling only or heating.
- It is possible to use the indoor units both in pair (connecting one indoor to one outdoor) and in multi applications (connecting up to 9 units in several rooms to 1 outdoor unit).

Capacity and power input

| COOLING ONLY - INVERTER CONTROLLED (air cooled) | | | | FDKS25E | FDKS35E | FDKS50C | FDKS60C | |
|--|-------------|-------------|----|-----------------|-----------------|----------------|----------------|---|
| | | | | RKS25D | RKS35D | RKS50E | RKS60E | |
| Cooling capacity | min~nom~max | kW | | 1.3~2.4~3.0 | 1.4~3.4~3.8 | 2.0~5.0~5.3 | 2.0~6.0~6.5 | |
| Nominal input | min~nom~max | kW | | 0.30~0.845~1.06 | 0.30~1.30~1.455 | 0.50~1.65~1.93 | 0.50~2.13~2.49 | |
| EER | | | | 2.84 | 2.62 | 3.03 | 2.82 | |
| Energy label | | | | C | D | B | C | |
| Annual energy consumption | kWh | | | 423 | 650 | 825 | 1,065 | |
| HEAT PUMP - INVERTER CONTROLLED (air cooled) | | | | FDXS25E | FDXS35E | FDXS50C | FDXS60C | |
| | | | | RXS25D | RXS35D | RXS50E | RXS60E | |
| Cooling capacity | min~nom~max | kW | | 1.3~2.4~3.0 | 1.4~3.4~3.8 | 2.0~5.0~5.3 | 2.0~6.0~6.5 | |
| Heating capacity | min~nom~max | kW | | 1.3~3.2~4.5 | 1.4~4.1~5.0 | 2.0~5.8~6.0 | 2.0~7.0~8.0 | |
| Nominal input | cooling | min~nom~max | kW | 0.30~0.845~1.06 | 0.30~1.30~1.455 | 0.50~1.65~1.93 | 0.50~2.13~2.49 | |
| | heating | min~nom~max | kW | 0.29~0.935~1.50 | 0.31~1.44~1.56 | 0.50~1.92~2.04 | 0.50~2.32~3.18 | |
| EER | | | | 2.84 | 2.62 | 3.03 | 2.82 | |
| COP | | | | 3.42 | 2.85 | 3.02 | 3.02 | |
| Energy label | cooling | | | | C | D | B | C |
| | heating | | | | B | D | D | D |
| Annual energy consumption | cooling | kWh | | 423 | 650 | 825 | 1,065 | |

Note: 1) Energy label: scale from A (most efficient) to G (less efficient).

2) Annual energy consumption: based on average use of 500 running hours per year at full load (=nominal conditions)

| POSSIBLE COMBINATIONS | | 2MXS40D (1) | 3MXS50E (1) | 4MXS58E (2) | 4MXS75E (2) | 5MXS90E (2) | 2MXS40D* (1) | 2MXS52E* (2) | 3MXS52E* (2) | 4MXS68E* (2) | 4MXS80E* (2) | 5MXS90E* (2) | RMXS112E* | RMXS140E* | RMXS160E* |
|-------------------------|---------|-------------|-------------|-------------|-------------|-------------|--------------|--------------|--------------|--------------|--------------|--------------|-----------|-----------|-----------|
| Max. n° of indoor units | | 2 | 3 | 4 | 4 | 5 | 2 | 2 | 3 | 4 | 4 | 5 | 7 | 8 | 9 |
| Cooling only | FDKS25E | • | • | • | • | • | | | | | | | | | |
| | FDKS35E | • | • | • | • | • | | | | | | | | | |
| | FDKS50C | | | • | • | • | | | | | | | | | |
| | FDKS60C | | | | • | • | | | | | | | | | |
| Heat pump | FDXS25E | | | | | | • | • | • | • | • | • | • | • | • |
| | FDXS35E | | | | | | • | • | • | • | • | • | • | • | • |
| | FDXS50C | | | | | | | • | • | • | • | • | • | • | • |
| | FDXS60C | | | | | | | | • | • | • | • | • | • | • |
| Max. cooling capacity | kW | 4.20 | 7.07 | 7.30 | 9.28 | 10.50 | 4.20 | 6.92 | 7.30 | 8.68 | 9.60 | 10.50 | 11.2 | 14.0 | 15.5 |
| Max. heating capacity | kW | N/A | N/A | N/A | N/A | N/A | 4.70 | 7.98 | 8.30 | 10.64 | 11.00 | 11.50 | 12.5 | 16.0 | 17.5 |
| Max. PI cooling | kW | 1.52 | 2.16 | 2.24 | 3.54 | 3.98 | 1.52 | 2.25 | 2.25 | 3.69 | 3.56 | 4.01 | 3.50 | 5.09 | 5.40 |
| Max PI heating | kW | N/A | N/A | N/A | N/A | N/A | 1.87 | 2.51 | 2.51 | 3.41 | 3.11 | 3.46 | 3.93 | 5.21 | 5.43 |

Notes:

1 For more detailed information, please consult our multi model/combination tables catalogue or your local dealer.

2 (1) The indicated cooling, heating capacities and power input are indicative and are those connected to wall mounted D (25,35 class) series

(2) The indicated cooling, heating capacities and power input are indicative and are those connected to wall mounted D (25,35 class) /E (50, 60 class) series

3 N/A means not applicable since this unit is a cooling only unit

4 *At least two indoor units should be connected to these multi outdoor units

Specifications indoor units

| COOLING ONLY | | | | FDKS25E | FDKS35E | FDKS50C | FDKS60C |
|----------------------|---------|--------|---------------------|---------------------------|-------------|---------------|----------------|
| Dimensions | HxWxD | | mm | 200x700x620 | | 200x900x620 | 200x1100x620 |
| Weight | | | kg | 21 | | 27 | 30 |
| Air flow rate | H/L/SL | | m ³ /min | 8.7~7.3~6.2 | 8.7~7.3~6.2 | 12.0~10.0~8.4 | 16.0~13.5~11.2 |
| Fan speed | | | steps | 5 steps, silent and auto | | | |
| Sound pressure level | H/L/SL | | dB(A) | 35/31/29 | 35/31/29 | 37/33/31 | 38/34/32 |
| Sound power level | H | | dB(A) | 53 | 53 | 55 | 56 |
| Piping connections | liquid | | mm | ø6.4 | | | |
| | gas | | mm | ø9.5 | | ø12.7 | |
| | drain | I.D. | mm | ø20.0 | | | |
| | | E.D. | mm | ø26.0 | | | |
| Heat insulation | | | | both liquid and gas pipes | | | |
| HEAT PUMP | | | | FDXS25E | FDXS35E | FDXS50C | FDXS60C |
| Dimensions | HxWxD | | mm | 200x700x620 | | 200x900x620 | 200x1100x620 |
| Weight | | | kg | 21 | | 27 | 30 |
| Air flow rate | cooling | H/L/SL | m ³ /min | 8.7~7.3~6.2 | 8.7~7.3~6.2 | 12.0~10.0~8.4 | 16.0~13.5~11.2 |
| | heating | H/L/SL | m ³ /min | 8.7~7.3~6.2 | 8.7~7.3~6.2 | 12.0~10.0~8.4 | 16.0~13.5~11.2 |
| Fan speed | | | steps | 5 steps, silent and auto | | | |
| Sound pressure level | cooling | H/L/SL | dB(A) | 35/31/29 | 35/31/29 | 37/33/31 | 38/34/32 |
| | heating | H/L/SL | dB(A) | 35/31/29 | 35/31/29 | 37/33/31 | 38/34/32 |
| Sound power level | cooling | H | dB(A) | 53 | 53 | 55 | 56 |
| Piping connections | liquid | | mm | ø6.4 | | | |
| | gas | | mm | ø9.5 | | ø12.7 | |
| | drain | I.D. | mm | ø20.0 | | | |
| | | E.D. | mm | ø26.0 | | | |
| Heat insulation | | | | both liquid and gas pipes | | | |

Indoor units: FDKS/FDXS-E FDKS/FDXS-C



Specifications outdoor units

| PAIR - COOLING ONLY | | | | RKS25D | RKS35D | RKS50E | RKS60E |
|--------------------------|---------|-----------|-------|--|--------|--------------|--------|
| Dimensions | HxWxD | | mm | 550x765x285 | | 735x825x300 | |
| Weight | | | kg | 30 | | 47 | |
| Casing colour | | | | ivory white | | | |
| Sound pressure level | H/L | | dB(A) | 46/43 | 47/44 | 47/44 | 49/46 |
| Sound power level | H | | dB(A) | 61 | 61 | 61 | 63 |
| Compressor | | | | hermetically sealed swing type | | | |
| Refrigerant type | | | | R-410A | | | |
| Refrigerant charge | | | kg/m | 0.02 (for piping length exceeding 10m) | | | |
| Maximum piping length | | | m | 20 | | 30 | |
| Maximum level difference | | | m | 15 | | 20 | |
| Operation range | | from ~ to | °CDB | -10~46 | | (-15*)-10~46 | |
| PAIR - HEAT PUMP | | | | RXS25D | RXS35D | RXS50E | RXS60E |
| Dimensions | HxWxD | | mm | 550x765x285 | | 735x825x300 | |
| Weight | | | kg | 30 | | 48 | |
| Casing colour | | | | ivory white | | | |
| Sound pressure level | cooling | H/L | dB(A) | 46/43 | 47/44 | 47/44 | 49/46 |
| | heating | H/L | dB(A) | 47/44 | 48/45 | 48/45 | 49/46 |
| Sound power level | cooling | H | dB(A) | 61 | 62 | 61 | 63 |
| Compressor | | | | hermetically sealed swing type | | | |
| Refrigerant type | | | | R-410A | | | |
| Refrigerant charge | | | kg/m | 0.02 (for piping length exceeding 10m) | | | |
| Maximum piping length | | | m | 20 | | 30 | |
| Maximum level difference | | | m | 15 | | 20 | |
| Operation range | cooling | from ~ to | °CDB | -10~46 | | -10~46 | |
| | heating | from ~ to | °CWB | -15~20 | | -15~18 | |

* Possibility to extend the operation range down to -15°C by turning on the switch on the outdoor unit PCD. In this case, the unit will stop operation at -20°C or lower and will recover when temperature rises again.

| MULTI - COOLING ONLY | | | | 2MKS40D | 3MKS50E | 4MKS58E | 4MKS75E | 5MKS90E | |
|--------------------------|--------------------------|-----------|-------|--------------------------------------|--------------------|--------------------|--------------------|--------------------|--------------------|
| Dimensions | HxWxD | | mm | 640x685x285 | 735x936x300 | | | 770x900x320 | |
| Weight | | | kg | 39 | 49 | 49 | 58 | 69 | |
| Casing colour | | | | ivory white | | | | | |
| Sound pressure level | H/L | | dB(A) | 47/43 | 46/* | 46/* | 48/* | 48/* | |
| Sound power level | H | | dB(A) | 62 | 59 | 59 | 61 | 61 | |
| Compressor | | | | hermetically sealed swing compressor | | | | | |
| Refrigerant type | | | | R-410A | | | | | |
| Refrigerant charge | | | kg/m | 0.02 (20m or more) | chargeless | | | 0.02 (65m or more) | |
| Maximum piping length | for total of each room | | m | 30 | 50 | 50 | 60 | 75 | |
| | for one room | | m | 20 | 25 | | | | |
| Maximum level difference | between indoor ~ outdoor | | m | 15 | 15 | | | | |
| | between indoor units | | m | 7.5 | 15 | | | | |
| Operation range | from ~ to | | °CDB | +10~46 | -10~46 | | | | |
| MULTI - HEAT PUMP | | | | 2MXS40D** | 2MXS52E** | 3MXS52E** | 4MXS68E** | 4MXS80E** | 5MXS90E** |
| Dimensions | HxWxD | | mm | 640x685x285 | 735x936x300 | | | 770x900x320 | |
| Weight | | | kg | 39 | 49 | 49 | 59 | 72 | 73 |
| Casing colour | | | | ivory white | | | | | |
| Sound pressure level | cooling | H/L | dB(A) | 47/43 | 46/* | 46/* | 48/* | 48/* | 52/* |
| | heating | H/L | dB(A) | 48/44 | 47/* | 47/* | 49/* | 49/* | 52/* |
| Sound power level | cooling | H | dB(A) | 62 | 59 | 59 | 61 | 61 | 65 |
| Compressor | | | | hermetically sealed swing compressor | | | | | |
| Refrigerant type | | | | R-410A | | | | | |
| Refrigerant charge | | | kg/m | 0.02 (20m or more) | 0.02 (30m or more) | 0.02 (30m or more) | 0.02 (30m or more) | 0.02 (30m or more) | 0.02 (30m or more) |
| Maximum piping length | for total of each room | | m | 30 | 50 | 50 | 60 | 70 | 75 |
| | for one room | | m | 20 | 25 | | | | |
| Maximum level difference | between indoor ~ outdoor | | m | 15 | 15 | | | | |
| | between indoor units | | m | 7.5 | 7.5 | | | | |
| Operation range | cooling | from ~ to | °CDB | +10~46 | -10~46 | | | | |
| | heating | from ~ to | °CWB | -10~15.5 | -15~15.5 | | | | |

* This information was not available at the time of publication.

| SUPER MULTI PLUS - HEAT PUMP | | | | RMXS112E** | RMXS140E** | RMXS160E** |
|------------------------------|------------------|-----------|-------|---------------------------------------|------------|------------|
| Dimensions | HxWxD | | mm | 1,345x900x320 | | |
| Weight | | | kg | 135 | | |
| Casing colour | | | | Ivory white | | |
| Sound pressure level | cooling | H | dB(A) | 51 | 52 | 54 |
| | heating | H | dB(A) | 53 | 54 | 55 |
| Sound power level | cooling | H | dB(A) | 67 | 68 | 70 |
| Compressor | | | type | hermetically sealed scroll compressor | | |
| Refrigerant type | | | | R-410A | | |
| Maximum piping length | system total | | m | 115 | 135 | 145 |
| | total OU - BP | | m | 55* | 55* | 55* |
| Maximum level difference | outdoor - indoor | | m | 30 | | |
| | outdoor - BP | | m | 30 | | |
| | BP - BP | | m | 15 | | |
| | indoor - indoor | | m | 15 | | |
| Operation range | cooling | from ~ to | °CDB | -5~46 | | |
| | heating | from ~ to | °CWB | -15~20 | | |

* The local piping length between 1st branch and indoor unit should be less than 40m.

** At least 2 indoor units should be connected to this Multi outdoor unit.



Accessories: control systems

| INDOOR UNITS | | FDK/XS25E | FDK/XS35E | FDK/XS50C | FDK/XS60C |
|--|---------------------------|-----------|-----------|-----------|-----------|
| Wiring adapter for time clock/ remote control (1) | normal open contact | | | KRP413A1S | |
| | normal open pulse contact | | | KRP413A1S | |
| Centralised control board | up to 5 rooms (2) | | | KRC72 | |
| Central remote control | | | | DCS302C51 | |
| Unified ON/OFF control | | | | DCS301B51 | |
| Schedule timer | | | | DST301B51 | |
| Interface adapter (3) | | | | KRP928A2S | |

- (1) Wiring adapter is supplied by Daikin. Timer and other devices: field supply.
 (2) Wiring adapter is also required for each indoor unit.
 (3) For DIII-NET adapter

Accessories

| INDOOR UNITS | FDK/XS25E | FDK/XS35E | FDK/XS50C | FDK/XS60C |
|--|-----------|-----------|-----------|-----------|
| Anti-theft protection for remote control | | | KKF917AA4 | |
| Suction grille | | | KDGF19A45 | |

Accessories

| OUTDOOR UNITS | PAIR (25,35 class)/MULTI (40 class) | MULTI (50-90class) | SUPER MULTI PLUS |
|---------------------------------|-------------------------------------|--------------------|------------------|
| Air direction adjustment grille | KPW937A4 | KPW945A4 | KPW945A4 |
| Refnet joint | - | - | KHRQ22M20TA |
| Branch provider (2 rooms) | - | - | BPMKS967A2 |
| Branch provider (3 rooms) | - | - | BPMKS967A3 |

Note:

- V1 = 1~, 220-240V, 50Hz / VM = 1~, 220-240/220-230V, 50Hz/60Hz
- Nominal cooling capacities are based on: indoor temperature 27°CDB/19°CWB • outdoor temperature 35°CDB • refrigerant piping length 7.5m • level difference 0m.
- Nominal heating capacities are based on: indoor temperature 20°CDB • outdoor temperature 7°CDB/6°CWB • refrigerant piping length 7.5m • level difference 0m.
- Capacities are net, including a deduction for cooling (an addition for heating) for indoor fan motor heat.
- Units should be selected on nominal capacity. Max. capacity is limited to peak periods.
- The sound pressure level is measured via a microphone at a certain distance from the unit (for measuring conditions: please refer to the technical databooks).
- The sound power is an absolute value indicating the "power" which a sound source generates.

In all of us,
a green heart



Daikin's unique position as a manufacturer of air conditioning equipment, compressors and refrigerants has led to its close involvement in environmental issues. For several years Daikin has had the intention to become a leader in the provision of environmental friendly products. This challenge demands the eco design and development of a wide range of products and an energy management system; which involves energy conservation and reduction of waste.



Daikin Europe N.V. is approved by LRQA for its Quality Management System in accordance with the ISO9001 standard. ISO9001 pertains to quality assurance regarding design, development, manufacturing as well as to services related to the product.



ISO14001 assures an effective environmental management system in order to help protect human health and the environment from the potential impact of our activities, products and services and to assist in maintaining and improving the quality of the environment.



Daikin units comply with the European regulations that guarantee the safety of the product.



Daikin Europe NV participates in the Eurovent Certification Programme for Air Conditioners (AC), Liquid Chilling Packages (LCP) and Fan Coil Units (FC); the certified data of certified models are listed in the Eurovent Directory. Multi units are Eurovent certified for combinations up to 2 indoor units.

The present leaflet is drawn up by way of information only and does not constitute an offer binding upon Daikin Europe N.V.. Daikin Europe N.V. has compiled the content of this leaflet to the best of its knowledge. No express or implied warranty is given for the completeness, accuracy, reliability or fitness for particular purpose of its content and the products and services presented therein. Specifications are subject to change without prior notice. Daikin Europe N.V. explicitly rejects any liability for any direct or indirect damage, in the broadest sense, arising from or related to the use and/or interpretation of this leaflet. All content is copyrighted by Daikin Europe N.V..

Daikin products are distributed by:

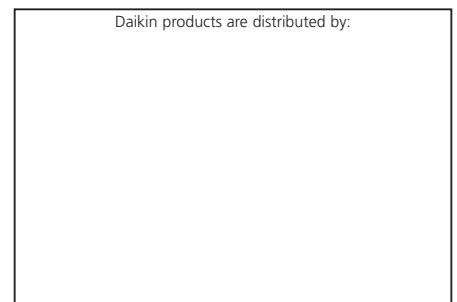

DAIKIN EUROPE N.V.

Zandvoordestraat 300
 B-8400 Oostende, Belgium
 www.daikineurope.com

Global Cooling Air Conditioning UK Prices*

Daikin Slim Concealed Ceiling Unit – COOLING ONLY TYPES

| Features | Nom cooling | Nom heating | Uk cool | UK Cool | Uk heat | - | - | Inter wires | - | - | Max pipe | - | - | - | Price | |
|---|--------------|--------------|---------|---------|---------|----------|------|-------------|--------|---------|------------|-----------|---------|-------|--------|-----------------|
| Daikin Inverter Models Cooling Only types below | Min~norm~max | Min~norm~max | T/C kw | S/C kw | kw | Run amps | Fuse | connecting | Liquid | Suction | separation | Max level | min amb | kg in | kg out | Exc Vat |
| FDKS25E+RKS25F | 1.3~2.4~3.0 | n/a | 2.4 | 1.9 | n/a | 3.8 | 15 | 3+e | 1/4" | 3/8" | 25 | 15 | -10 | 12 | 37 | £791.70 |
| FDKS35E+RKS35F | 1.4~3.4~3.8 | n/a | 3.4 | 2.3 | n/a | 5.5 | 15 | 3+e | 1/4" | 3/8" | 25 | 15 | -10 | 12 | 37 | £904.17 |
| FDKS50C+RKS50G | 1.7~5.0~5.3 | n/a | 4.9 | 3.2 | n/a | 7.3 | 20 | 3+e | 1/4" | 1/2" | 30 | 20 | -10 | 15 | 49 | £1047.22 |
| FDKS60C+RKS60F | 1.7~6.0~6.5 | n/a | 6.0 | 4.1 | n/a | 9.3 | 20 | 3+e | 1/4" | 1/2" | 30 | 20 | -10 | 20 | 53 | £1143.32 |



*Please check the following page for latest specifications.

<http://global-cooling.co.uk/airconditioning/air-conditioning-brands/daikin-air-conditioning/concealed-air-conditioning/>

Please see the next page for heat pump type prices.

Global Cooling Air Conditioning UK Prices*

Daikin Slim Concealed Ceiling Unit – HEAT PUMP TYPES

| Features | Nom cooling | Nom heating | UK cool | UK Cool | UK heat | - | - | Inter wires | - | - | Max pipe | - | - | - | - | Price |
|---|--------------|--------------|---------|---------|---------|----------|------|-------------|--------|---------|------------|-----------|---------|-------|--------|-----------------|
| Daikin Inverter Models Cooling Only types below | Min~norm~max | Min~norm~max | T/C kw | S/C kw | kw | Run amps | Fuse | connecting | Liquid | Suction | separation | Max level | min amb | kg in | kg out | Exc Vat |
| FDXS25E+RKS25F | 1.3~2.4~3.0 | 1.3~3.2~4.5 | 2.4 | 1.9 | 2.4 | 3.8 | 15 | 3+e | 1/4" | 3/8" | 25 | 15 | -10 | 12 | 37 | £850.66 |
| FDXS35E+RKS35F | 1.4~3.4~3.8 | 1.4~4.0~5.0 | 3.4 | 2.3 | 3.0 | 5.5 | 15 | 3+e | 1/4" | 3/8" | 25 | 15 | -10 | 12 | 37 | £969.89 |
| FDXS50C+RKS50G | 1.7~5.0~5.3 | 1.7~5.8~6.0 | 4.9 | 3.2 | 4.3 | 7.3 | 20 | 3+e | 1/4" | 1/2" | 30 | 20 | -10 | 15 | 49 | £1142.23 |
| FDXS60C+RKS60F | 1.7~6.0~6.5 | 1.7~7.0~8.0 | 6.0 | 4.1 | 5.2 | 9.3 | 20 | 3+e | 1/4" | 1/2" | 30 | 20 | -10 | 20 | 53 | £1238.32 |



*Please check the following page for latest specifications.

<http://global-cooling.co.uk/airconditioning/air-conditioning-brands/daikin-air-conditioning/concealed-air-conditioning/>

If you need any help please call us on 01200 428888